



INDIANA UNIVERSITY
CAPITAL PROJECTS

Addendum #2

Project: 20251391 - IN076 ICTC – IT 427 431 440C 557 Office Divisions

Date: June 23, 2026

This Addendum, issued prior to bidding, alters, amends, corrects, or clarifies the Construction Bid Documents to the extent stated herein and does thereby become a part of the Construction Bid Documents, and will become part of the Contract Documents of the successful bidder. Acknowledge receipt of this Addendum in the space provided on the Bid Form. Failure to do so may subject the Bidder to disqualification.

ITEMS INCLUDED IN THIS ADDENDUM

Item 1 – Questions and Answers

Q1. I would like clarification on a door discrepancy between the architectural drawings and the door schedule. On A201, in the Room 431/431A plan, it is indicated by notes 5 & 9 that door 431-1 is new. On the same drawing, it is indicated by lack of note 5 & 9 that door 431A-1 is not new. However, the door schedule lists 431A-1 for a new door and does not list 431-1.

Based on the demolition plan (A101), I assume that 431-1 is the only new door for room 431, and that in the door schedule “431A-1” should actually be listed as “431-1.” Please let me know if this is the correct assumption.

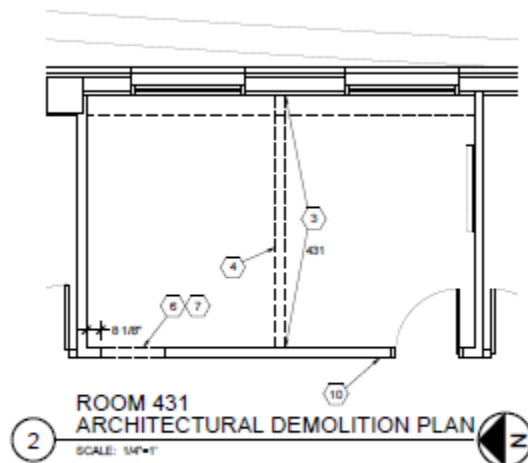

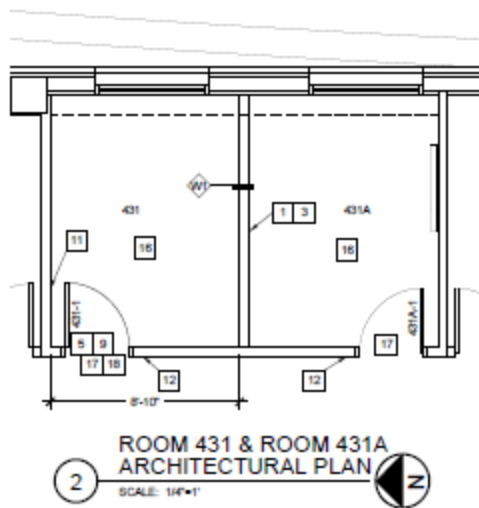

DOOR SCHEDULE													NOTES
DOOR NUMBER	SIZE			ELEV.	MAYL.	FINISH	HOW SET	FRAME					
	WID.	HGT.	THC.					MAT.	FN.	ELEV.	JAMB DTL.	HEAD DET.	
427A-1	3'-0"	7'-0"	1-3/4"	3/AS01	SCW			REL	P	3/AS01	1/AS01	1/AS01	4
431A-1	3'-0"	7'-0"	1-3/4"	3/AS01	SCW			HM		3/AS01	1/AS01	1/AS01	
460CA-1	3'-0"	7'-0"	1-3/4"	3/AS01	SCW			HM		3/AS01	1/AS01	1/AS01	
557A-1	3'-0"	7'-0"	1-3/4"	ETR	ETR	ETR		HM		3/AS01	2/AS01	2/AS01	1

NOTES:

1. RELOCATED FRAME. CONFIRM HINGE TYPE AND QUANTITY.
2. RELOCATED DOOR AND FRAME.
3. ABBREVIATIONS:
 - SCW - SOLID CORE WOOD
 - HM - HOLLOW METAL
 - NA, N/A - NOT APPLICABLE
 - ETR - EXISTING TO REMAIN
 - REL - RELOCATED
 - P - PAINT
 - ST - STAIN (TO MATCH EXISTING)
4. EXISTING DOOR FRAME IN ROOM 557 SHALL BE RELOCATED TO ROOM 427
5. DOOR SHALL BE GRADE "AA", QUARTER SLICED, WHITE MAPLE, SLIP AND BALANCE MATCH, TO MATCH ALOOMA HARDWOODS, INC., EGGERS INDUSTRIES, MARSHFIELD DOOR SYSTEMS, INC., OR VT INDUSTRIES TYPE.

A1. Correct. Door 431A-1 is the existing door into the space and it will remain. Door 431-1 is a new door.

END OF ADDENDUM 2